



# DS-610

ORDERCODE D1128



**SHOWELECTRONICS FOR PROFESSIONALS**

## **Congratulations!**

You have bought a great, innovative product from DAP Audio.

The DAP Audio DS-610 brings excitement to any venue. Whether you want simple plug-&-play action or a sophisticated show, this product provides the effect you need.

You can rely on DAP Audio, for more excellent audio products.

We design and manufacture professional audio equipment for the entertainment industry.

New products are being launched regularly. We work hard to keep you, our customer, satisfied.

For more information: [iwant@dap-audio.info](mailto:iwant@dap-audio.info)

You can get some of the best quality, best priced products on the market from DAP Audio.

So next time, turn to DAP Audio for more great audio equipment.

Always get the best -- with DAP Audio !

Thank you!



# Dap Audio

---

## Dap Audio DS-610™ Product Guide

<b>Warning</b>	2
Unpacking Instructions	2
Safety-instructions	2
Operating Determinations	3
Return Procedure	4
Claims	4
<b>Description</b>	5
Overview	5
Frontview	6
Rearview	6
Remote Control	7
<b>Installation</b>	8
<b>Set Up and Operation</b>	8
<b>Functions</b>	8
<b>Operations</b>	10
Selecting Tracks using the Skip Buttons	10
Starting Playback	10
Stop Playback	10
Pausing	10
Setting a Cue Point	10
Cueing	11
Scanning (Fast forward/Fast backward)	11
Time Display	11
Changing Pitch of the song	11
Program Play	11
Loop Play	12
Reloop	12
Repeat	12
<b>Maintenance</b>	12
<b>Troubleshooting</b>	12
<b>Product Specifications</b>	13

## WARNING

**FOR YOUR OWN SAFETY, PLEASE READ THIS USER MANUAL CAREFULLY  
BEFORE YOUR INITIAL START-UP!**

### Unpacking Instructions

Immediately upon receiving this product, carefully unpack the carton and check the contents to ensure that all parts are present, and have been received in good condition. Notify the dealer immediately and retain packing material for inspection if any parts appear damaged from shipping or the carton itself shows signs of mishandling. Save the carton and all packing materials. In the event that a fixture must be returned to the factory, it is important that the fixture be returned in the original factory box and packing.

Your shipment includes:

- DAP DS-610
- Remote control
- 2x AAA battery
- Stereo RCA cable – 1,5m
- Power Cable – 2m
- User manual



#### CAUTION!

**Keep this system away from rain and moisture!**



### SAFETY INSTRUCTIONS

Every person involved with the installation, operation and maintenance of this system has to:

- be qualified
- follow the instructions of this manual



**CAUTION! Be careful with your operations.  
With a dangerous voltage you can suffer  
a dangerous electric shock when touching the wires!**



Before you initial start-up, please make sure that there is no damage caused by transportation. Should there be any, consult your dealer and do not use the system.

To maintain perfect condition and to ensure a safe operation, it is absolutely necessary for the user to follow the safety instructions and warning notes written in this manual.

Please consider that damages caused by manual modifications to the system are not subject to warranty.

This system contains no user-serviceable parts. Refer servicing to qualified technicians only.

#### IMPORTANT:

*The manufacturer will not accept liability for any resulting damages caused by the non-observance of this manual or any unauthorized modification to the system.*

- Never let the power-cord come into contact with other cables! Handle the power-cord and all connections with the mains with particular caution!

- Never remove warning or informative labels from the unit.
- Never use anything to cover the ground contact.
- Never leave any cables lying around.
- Do not insert objects into air vents.
- Do not connect this system to a dimmerpack.
- Do not switch the system on and off in short intervals, as this would reduce the system's life.
- Do not open the device and do not modify the device.
- Do not drive the inputs with a signal level bigger, than required to drive the equipment to full output.
- Do not plug Mics into the console (or stagebox) while Phantom Power is on. Also mute the monitor / Pa system when turning Phantom Power on or off. Allow the system to adjust for a couple of seconds, before setting the input gains.
- Only use system indoor, avoid contact with water or other liquids.
- Avoid flames and do not put close to flammable liquids or gases.
- Always disconnect power from the mains, when system is not used. Only handle the power-cord by the plug. Never pull out the plug by tugging the power-cord.
- Always operate the unit with the AC ground wire connected to the electrical system ground.
- Make sure you don't use the wrong kind of cables or defective cables.
- Make sure that the signals into the mixer are balanced, otherwise hum could be created.
- Make sure you use DI boxes to balance unbalanced signals; All incoming signals should be clear.
- Make sure that the available voltage is not higher than stated on the rear panel.
- Make sure that the power-cord is never crimped or damaged. Check the system and the power-cord from time to time.
- Please turn off the power switch, when changing the power cord or signal cable, or select the input mode switch.
- Extreme frequency boosts in connection with a high input signal level may lead to overdriving your equipment. Should this occur, it is necessary to reduce the input signal level by using the INPUT control.
- To emphasize a frequency range, you don't necessarily have to move its respective control upward; try lowering surrounding frequency ranges instead. This way, you avoid causing the next piece of equipment in your sound path to overdrive. You also preserve valuable dynamic reserve ("headroom")
- Avoid ground loops! Always be sure to connect the power amps and the mixing console to the same electrical circuit to ensure the same phase!
- If system is dropped or struck, disconnect mains power supply immediately. Have a qualified engineer inspect for safety before operating.
- If the system has been exposed to drastic temperature fluctuation (e.g. after transportation), do not switch it on immediately. The arising condensation water might damage your system. Leave the system switched off until it has reached room temperature.
- If your Dap Audio device fails to work properly, discontinue use immediately. Pack the unit securely (preferably in the original packing material), and return it to your Dap Audio dealer for service.
- Repairs, servicing and electric connection must be carried out by a qualified technician.
- For replacement use fuses of same type and rating only.
- WARRANTY: Till one year after date of purchase.

## OPERATING DETERMINATIONS

This system is not designed for permanent operation. Consistent operation breaks will ensure that the system will serve you for a long time without defects.

If this system is operated in any other way, than the one described in this manual, the product may suffer damages and the warranty becomes void.

Any other operation may lead to dangers like short-circuit, burns, electric shock, etc.

You endanger your own safety and the safety of others!

**Improper installation can cause serious damage to people and property !**

## Connection with the mains

Connect the device to the mains with the power-plug.

Always pay attention, that the right color cable is connected to the right place.

International	EU (including UK) From April 2004	North America	Pin
L	Brown	Black	Phase
N	Blue	White	Neutral
	Green/Yellow	Green	Protective Earth

**Make sure that the device is always connected properly to the earth!**

## Return Procedure

Returned merchandise must be sent prepaid and in the original packing, call tags will not be issued. Package must be clearly labeled with a Return Authorization Number (RMA number). Products returned without an RMA number will be refused. Highlite will not accept the returned goods or any responsibility. Call Highlite 0031-455667723 or mail [offersales@highlite.nl](mailto:offersales@highlite.nl) and request an RMA prior to shipping the fixture. Be prepared to provide the model number, serial number and a brief description of the cause for the return. Be sure to properly pack fixture, any shipping damage resulting from inadequate packaging is the customer's responsibility. Highlite reserves the right to use its own discretion to repair or replace product(s). As a suggestion, proper UPS packing or double-boxing is always a safe method to use.

**Note: If you are given an RMA number, please include the following information on a piece of paper inside the box:**

- 1) Your name
- 2) Your address
- 3) Your phone number
- 4) A brief description of the symptoms

## Claims

The client has the obligation to check the delivered goods immediately upon delivery for any shortcomings and/or visible defects, or perform this check after our announcement that the goods are at their disposal. Damage incurred in shipping is the responsibility of the shipper; therefore the damage must be reported to the carrier upon receipt of merchandise.

It is the customer's responsibility to notify and submit claims with the shipper in the event that a fixture is damaged due to shipping. Transportation damage has to be reported to us within one day after receipt of the delivery.

Any return shipment has to be made post-paid at all times. Return shipments must be accompanied with a letter defining the reason for return shipment. Non-prepaid return shipments will be refused, unless otherwise agreed in writing.

Complaints against us must be made known in writing or by fax within 10 working days after receipt of the invoice. After this period complaints will not be handled anymore.

Complaints will only then be considered if the client has so far complied with all parts of the agreement, regardless of the agreement of which the obligation is resulting.

## Description of the device

### Features

The Darkshade DS-610 is a fully digital media player. It can read both SD-card and USB-stick and can play any MP3 song you want. The big bright LCD display makes selecting songs very fast and easy.

- Continues and Single Play Mode
- Folder Search
- Track Search
- Auto Cue
- Seamless Loop

### Overview

#### Top



**Fig. 1**

## Frontview

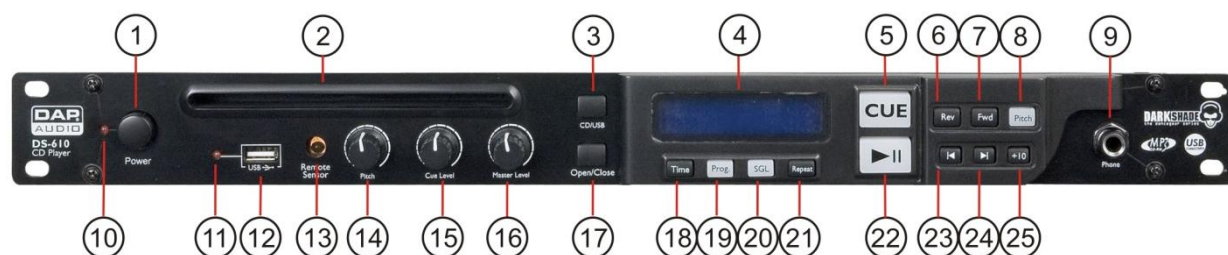

**Fig. 2**

- |                           |                            |
|---------------------------|----------------------------|
| 1) Power ON/ OFF Switch   | 14) Pitch Control          |
| 2) CD slot                | 15) Cue Level Control      |
| 3) CD/ USB Button         | 16) Master Volume Control  |
| 4) LCD Display            | 17) Open/ Close            |
| 5) Cue Button             | 18) Time Button            |
| 6) Reverse Button         | 19) Program Button         |
| 7) Fast Forward Button    | 20) Single Button          |
| 8) Pitch Button           | 21) Repeat Button          |
| 9) Phone Output Connector | 22) Play/Pause ►/   Button |
| 10) Power ON LED          | 23) B. Skip ◀  Button      |
| 11) USB LED               | 24) F. Skip ▶  Button      |
| 12) USB slot              | 25) +10 Button             |
| 13) Remote Sensor         |                            |

## Rearview



**Fig. 3**

- 26) RCA Stereo Unbalanced Line Out Connectors
- 27) RCA Stereo Unbalanced Rec Out Connectors
- 28) AC Power Inlet

## Remote Control

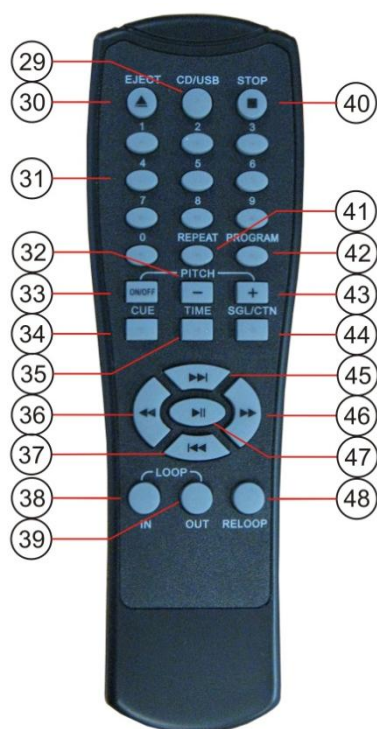

**Fig. 4**

**29)** CD/ USB Button

**30)** Eject Button

**31)** Direct Acces Buttons

**32)** Pitch – Button

**33)** Pitch Button

**34)** Cue Button

**35)** Time Button

**36)** Fast Backward ◀◀ Button

**37)** B. Skip ◀◀ Button

**38)** Loop In Button

**39)** Loop Out Button

**40)** Stop Button

**41)** Repeat Button

**42)** Program Button

**43)** Pitch + Button

**44)** SGL Button

**45)** F. Skip ▶▶| Button

**46)** Fast Forward ▶▶ Button

**47)** Play/Pause Button

**48)** Reloop Button

# Installation

Remove all packing materials from the DS-610. Check that all foam and plastic padding is removed..  
Connect all cables.

**Always disconnect from electric mains power supply before cleaning or servicing.**  
**Damages caused by non-observance are not subject to warranty.**

## Set Up and Operation

Before plugging the unit in, always make sure that the power supply matches the product specification voltage. The power supply is printed on the back of the device.  
Do not attempt to operate a 120V specification product on 230V power, or vice versa.

Connections

1. Turn off the POWER switch.
2. Use RCA cables to connect the Line out outputs to a line input on your mixer.

## Functions

### NAMES AND FUNCTIONS

Below is a description of the functions of the controls.

### CD-player Functions

#### 1. Power ON/OFF

This is the main power switch. Press to turn the device on.

#### 2. CD-slot

#### 3/ 29. CD/ USB button

Use this button to switch between **CD slot (2)** or **USB slot (12)**. USB Selection is indicated by the **USB LED (20)**.

#### 4. LCD Display

#### 5/ 34. Cue:

Press this button during playback to return to the position at which playback is started.

#### 9. Phone

You can connect a pair of headphones with an impedance of 32 - 600 Ohm to the headphones connector. It is a 6.3mm/ 1/4" TRS socket, wired as Tip=left, Ring=right and sleeve = ground.

**Caution:** Depending on the type of headphones connected to the Headphones jack, the DS-610 is capable of producing high output levels via the phones output. Therefore, make sure to turn the control all the way to the left (minimum setting) before connecting the headphones. Be aware of the fact that listening to loud sound pressure levels over a longer period of time leads to hearing damage!

#### 10. Power LED

Indicates that the DS-610 is switched on.

#### 11. USB LED

When lit, the **USB slot (12)** is selected.

#### 12. USB-slot

Allows the connection of any USB memory stick.

#### 14. Pitch Control:

Use this control to adjust the pitch of the track. Turn to the right to increase the pitch, turn to the left to decrease the pitch.

#### 15. Cue Level

This control allows you to adjust the level of the **Phone (9)** output.

#### 16. Master

You can adjust the output signal to the **Line Outputs (26)**.

#### 17/ 30. Open/ Close (Eject)

Press this button to eject the CD from the **disc slot**. The **disc slot** cannot be opened during playback, so stop playback before pressing the button.

**18/ 35. Time:**

Press this button to switch the Time-Display between the elapsed time and remaining time.

**20/ 44. Single (SGL):**

Press this button to switch between the single and continuous play mode. If single mode is selected, the button is lit. In single mode, the unit stops playing after each track. In continuous mode, the unit plays all tracks and then stops.

**21/ 41. Repeat:**

Use this button to repeat one track or all tracks of your medium.

**26. RCA Unbalanced Line Out**

Use these outputs to connect a mixer with unbalanced RCA inputs.

**27. RCA Unbalanced Rec Out**

Use these outputs to connect a recorder with unbalanced RCA inputs.

**28. Mains 80 - 260Vac 50/60Hz inlet**

Use the supplied power cable to connect the device to the mains.

**31. Direct Acces Buttons**

Use to select a track directly.

**32. Pitch -:**

The CD slows down while this button is pressed. Release the button to return to the original BPM.

**33. Pitch:**

If you push this button, you can adjust the pitch with the **Pitch Control (14)**.

**36. Fast Reverse ◀◀ :**

Press and hold this button to play the track fast reverse.

**37. B.Skip |◀◀ Button**

Use this button to go back to the beginning of the current track or select a previous track for playing.

**38. Loop IN:**

Press this button to set the startpoint of the loop.

**39. Loop OUT:**

Press this button to set the endpoint of the loop.

**40. Stop Button**

Press this button to stop playback.

**42. Program**

**43. Pitch +:**

The CD speeds up as long as this button is pressed. Release the button to return to the original BPM.

**45. F.Skip ▶▶| Button**

Use this button to skip to the next track.

**46. Fast Forward ▶▶ :**

Press and hold this button to play the track fast forward.

**47. Play/ Pause-button ▶/|| :**

Use this button to start playback. Press once to start playback, twice to set the pause mode, and again to resume playback.

**48. Reloop:**

This button is used to start the last saved loop. To finish the loop, press the button again.

## Operations

### 1. Selecting Tracks Using the Skip buttons

- Press the Skip-buttons to move to a higher or lower track.
- Hold the Skip- buttons to change tracks continuously at a higher speed.
- When a new track is selected during playback, playback begins as soon as the skip search operation is completed.
- If the Skip-button ►► is pressed while at the last track, the first track is selected. In the same way, If the Skip- button ◀◀ is pressed while at the first track, the last track is selected.

### 2. Starting Playback

- Press the **Play/Pause** button during the pause or cue condition to start playback, the **Play** indicator lights.
- The point at which playback starts is automatically stored in the memory as the cue point. The CD player then returns to the cue point when the **Cue** button is pressed.

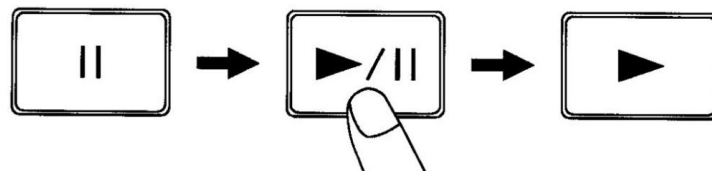

Fig. 5

### 3. Stop Playback

There are two ways to stop playback:

1. Press the **Play/Pause** button during playback to pause at that point.
2. Press the **Cue** button during playback to return to the cue point and enter pause condition.

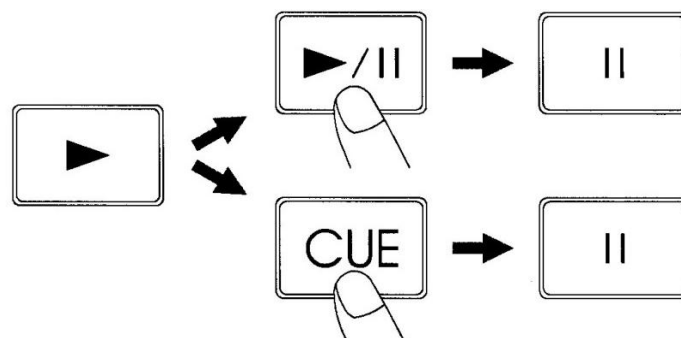

Fig. 6

### 4. Pausing

- Press the **Play/Pause** button to switch between play and pause.
- The **play** indicator flashes when the pause mode is set.
- Playback resumes when the **Play/Pause** button is pressed again.

### 5. Setting a Cue Point

- Press the **Play/Pause** button to switch between play and pause.
- The play indicator flashes when the pause mode is set.
- Use the **Fast Backwards** and **Fast Forwards** buttons to go to your desired Cue point.
- Press the **Play/Pause** button again and your Cue point has been stored and the CD will continu.

## 6. Cueing

- "Cueing" is the action of preparing for playback.
- Press the **Cue** button, the player will enter Cue-Mode, the playback returns to cue point and enters pause condition, the Cue indicator lights up and the **Play** indicator flashes. When **Play/Pause** button is pressed, play starts from the cue point.
- When the track search operation is completed after pressing the **Skip** buttons, the player automatically finds the position at which the sound starts and cues there (Auto Cue).
- If the **Cue** button is pressed after the search operation or the scanning operation, the playback returns to the cue point and enters pause condition.

**NOTE:** During cue mode, if the **Cue** button is pressed and hold, playback will start from the cue point, when the button is released, the player will return to the cue mode automatically, it allows you to check the cue point.

## 7. Scanning (Fast forward/Fast backward)

- Scanning is a function for moving quickly forward or backward while pressing the **Fast Forward** or **Fast Backwards** buttons.
- Press the **Fast Forward** or **Fast Backwards** button to start scanning. The disc moves rapidly forward or backward and the sound is audible. The current scan point is indicated on the LCD.

## 8. Time Display

Press the **Time** button to select time display mode:

1. Elapsed time of a track.
2. Remaining time of a track.

## 9. Changing Pitch of the song

There are three tools available for matching the BPM of the CD:

1. Use the **Pitch Control** to adjust the BPM.
2. Use the **Pitch Bend** buttons to change the BPM temporarily.

### 1) Pitch-Control

- To adjust the BPM by turning pitch control to the left or to the right, press the **Pitch** button to turn on the Pitch adjustment function.
- Slide the **Pitch Control** to the left to decrease BPM, or to the right to increase BPM. The adjustment range is  $\pm 24\%$ .

### 2) Pitch-Bending

- The BPM increases or decreases respectively while the Pitch Bend **+** or Pitch Bend **-** button is pressed.
- The BPM increase depends on how long you hold the button. If you hold the button for about 5 seconds, the BPM will go either to  $+24\%$  for Pitch Bend **+** or  $-24\%$  for Pitch Bend **-**. If you tap the button, the BPM will only change a little so you can change the beat slightly without audible changing in the music.
- The CD will return to the BPM indicated by the **Pitch Control** when you release the Pitch Bend **+** or Pitch Bend **-** buttons.

## 10. Program Play (only in CD mode)

1. Press the **Prog** button, the player will enter the program mode and the CD will stop rotating.
2. Select the desired track by pressing the **Skip** button or a **direct access button**, then press the **Prog** button again. The selected track will be added to the program sequence.
3. Repeat step 2. A maximum of 20 tracks can be programmed.
4. Press the **Play/Pause** button to start the program play from the first selection.
5. Press the **Prog** button again during program play to stop playing.
6. Press and hold the button more than 2 seconds to cancel the program mode and erase all the current program contents.

## 11. Loop PLAY

1. Press the Loop **IN** button to set the loop start point, the Loop indicator will flash on the LCD.
2. Press the Loop **OUT** button to set the loop end point. After the end point is set, the playback will enter the loop play from start point to end point repeatedly.
3. Press one of the Loop buttons again, the loop play function is canceled, the Loop indicator dims.

## 12. Reloop

1. If you press the **Reloop** button, the disc will go back to the last selected loop.
2. Press the button over and over rapidly to start the loop again and again.
3. Press one of the Loop buttons again, the loop play function is canceled, the Loop indicator dims.

## 13. Repeat

1. Press the **Repeat** button once to repeat the current track. The display shows "1".
2. Press the **Repeat** button again to repeat the whole folder. The display shows "F".
3. Press the **Repeat** button again to repeat the whole USB stick or SD card. The display shows "A".
4. Press the **Repeat** button a fourth time, to exit the Repeat Mode.

## Before switching off the power

When you have finished using the CD player. Press the **Open/ Close**  button. When the disc is completely ejected, take out the disc without using force. Now you can safely switch off the power.

### CAUTION:

- Do not try to insert the disc when the power is off.
- Do not switch off the power, while the disc is ejecting.
- Switch off the power after the disc has been completely ejected.

## CD's

### 1. Precautions on handling compact discs

- Do not allow fingerprints, oil or dust to get on the surface of the disc. If the disc is dirty, wipe it off with a soft dry cloth.
- Do not use thinner, water, record spray, electrostatic-proof chemicals, or silicone-treated cloths to clean discs.
- Always handle discs carefully to prevent damaging the surface; in particular when removing a disc from its case or returning it.
- Do not bend the disc.
- Do not put the CD near heating sources.
- Do not enlarge the hole in the center of the disc.
- Do not write on the label (printed side) with a hard-tipped implement such as a pencil or ball point pen.
- Condensation will form if a disc is brought into a warm area from a colder one, such as outdoors in winter. Do not attempt to dry the disc with a hair dryer, etc.

### 2. Precaution on storage

- After playing a disc, always unload it from the player.
- Always store the disc in the jewel case to protect from dirt or damage.
- Do not place discs in the following areas:
  1. Areas exposed to face sunlight for a considerable time.
  2. Areas subject to accumulation of dust or high humidity.
  3. Areas that are affected by heat from indoor heaters, etc.

## Maintenance

The DAP DS-610 requires almost no maintenance. However, you should keep the unit clean. Disconnect the mains power supply, and then wipe the cover with a damp cloth. Do not immerse in liquid. Do not use alcohol or solvents.

Keep connections clean. Disconnect electric power, and then wipe the audio connections with a damp cloth. Make sure connections are thoroughly dry before linking equipment or supplying electric power.

## Troubleshooting

DAP DS-610

This troubleshooting guide is meant to help solve simple problems. If a problem occurs, carry out the steps below in sequence until a solution is found. Once the unit operates properly, do not carry out following steps.

1. If the device does not operate properly, unplug the device.
2. Check power from the wall, all cables, connections, etc.
3. If all of the above appears to be O.K., plug the unit in again.
4. If nothing happens after 30 seconds, unplug the device.
5. Return the device to your DAP Audio dealer.

## Product Specification

Power supply: AC 80-260 V - 50/60 Hz

Power consumption: 5 Watt

Pitch control: 24% +/-

S/N ratio: >96 dB

Frequency response: 20 Hz - 20 kHz

Headphone connector: 6,3 mm jack

Audio output: Stereo RCA unbalanced

Dimensions: 482 x 45 x 260 mm (LxWxH)

Weight: 2,75 kg



Design and product specifications are subject to change without prior notice.



Website: [www.Dap-audio.info](http://www.Dap-audio.info)

Email: [service@highlite.nl](mailto:service@highlite.nl)



© 2009 DapAudio.